

# CleverMic ePTZ B51 4K

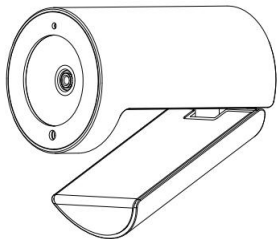

## User Manual V1.0

# Explanation

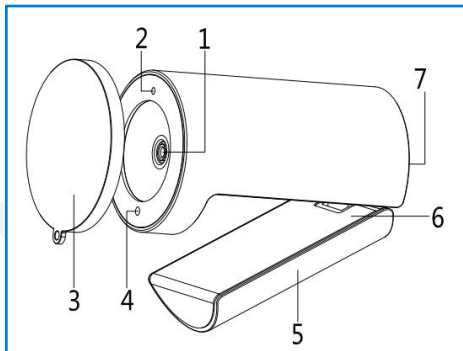

- |                            |               |
|----------------------------|---------------|
| 1. High quality glass lens | 2. LED light  |
| 3. Privacy lens cover      | 4. Microphone |
| 5. Clip mount              | 6. Spindle    |
| 7. USB Type-C port         |               |

# Product Features

---

## UHD

1/2.8" 12MP Ultra high definition CMOS sensor.

---

View Angle: **80°**(Diagonal); **65°**(Horizontal).

---

## 10cm

Object distance: 10cm~infinity.

---

## DZoom

Support 1.5~3X digital zoom.

---

## PDAF

Phase detection auto focus.

---

## ePTZ

Electronic Pan-Tilt-Zoom.

---

Support both **Landscape** and **Portrait** video display, flexible to meet different application.

# USB Type-C Port

A USB Type-C cable provides video output, camera control, power supply, and program upgrade.

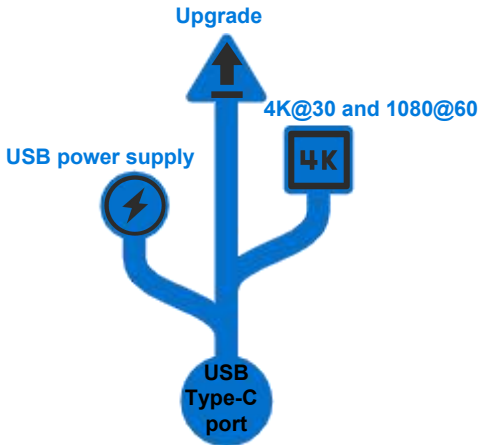

# Connection

1. Connect your computer to the webcam via the included USB Type-C cable (1.5m).

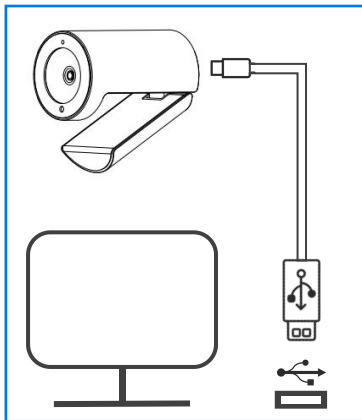

2. Plug and play, no need to install any driver, supports the standard UVC protocol.

3. The LED will light up when the app is using the webcam.

# Video Format

Output both MJPG and YUY2 two compression video, capable of supporting 3840\*2160@30 and 1920\*1080@60.

Supports Windows, MAC OS, Android, Chrome and Linux operating systems.

## MJPG

### Portrait video:

1080\*1920@30/15;  
720\*1280@30/15;  
576\*1024@30/15;  
360\*480@30/15

### Landscape video:

4000\*3000@15/10; 3840\*2160@30/10;  
2560\*1440@20/10; 1920\*1080@60/30;  
1280\*720@60/30; 1024\*576@60/30;  
640\*480@20/10

1280\*720@12/5;  
1024\*576@20/10;  
640\*480@30/20

## YUY2

# Mic Parameters

Built-in high-quality microphone, clear and comfortable sound pickup.

Omnidirectional  
microphone

Sensitivity:  
 $-26 \pm 2\text{dB}$   
 $R_L = 2.2\text{K}\Omega$   
 $V_s = 2.0\text{V}$



S/N Ratio:  
64dB

Pickup distance:  
3~5m

# Installation Mode

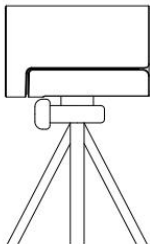

(A)

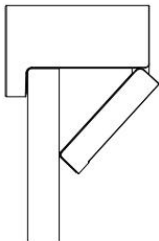

(B)

(A) The webcam is fixed on the tripod(not Provided).

(B) The webcam is fixed to the top of the display.



# Size & Weight

Webcam Size: 76mm×φ48mm

Package Size: 114.5mm×87mm×85mm

## Webcam size

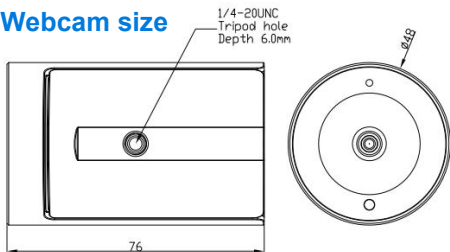

Net Weight: 0.13kg

Gross Weight: 0.3kg

